

DESSAU RIDGE OFFICE CONDOMINIUMS

508 DESSAU RIDGE LANE

THIS PLAN IS THE PROPERTY OF PFA DESIGN GROUP, INC. AND IS NOT TO BE REPRODUCED OR TRANSMITTED IN ANY FORM OR BY ANY MEANS, ELECTRONIC OR MECHANICAL, INCLUDING PHOTOCOPYING, RECORDING, OR BY ANY INFORMATION STORAGE AND RETRIEVAL SYSTEM, WITHOUT THE WRITTEN PERMISSION OF PFA DESIGN GROUP, INC. ALL RIGHTS ARE RESERVED.

APPROVED
 ARCHITECT
 PFA DESIGN GROUP, INC.
 508 DESSAU RIDGE LANE
 AUSTIN, TEXAS 78746
 DATE: 11/11/03
 BY: [Signature]



SHEET
A-1
 of 14
 PLAN
 44.352

The
 ARC

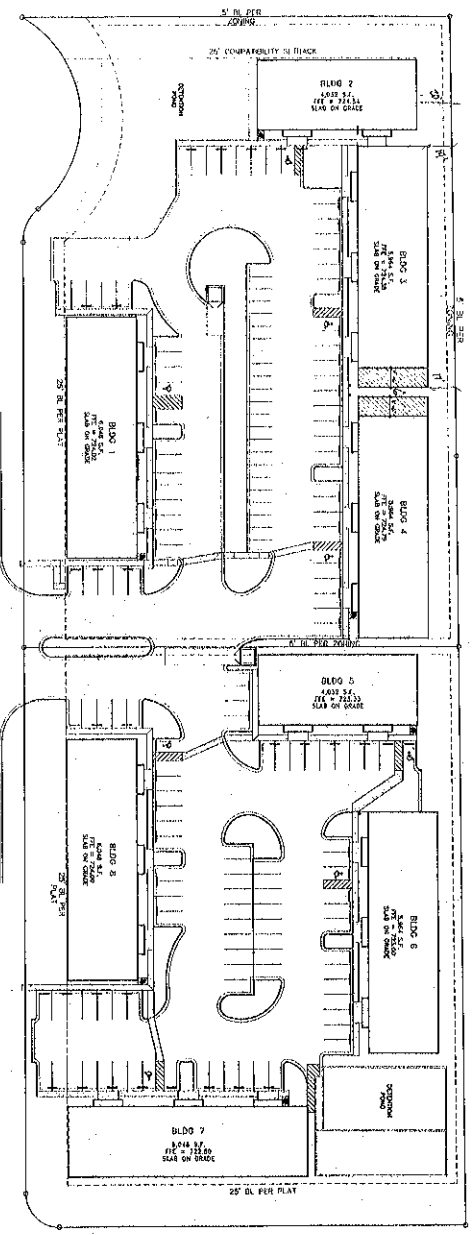

DESSAU ROAD

DESSAU RIDGE LANE

AREA INFORMATION: TOTAL AREA: 100,000 SQ. FT. (APPROXIMATE)
 CONSTRUCTION: CONCRETE ON GRADE
 FINISHES: POLISHED CONCRETE FLOORS, GYP. BOARD WALLS, GYP. BOARD CEILING
 MECHANICAL: CENTRAL AIR CONDITIONING, VAV SYSTEMS
 ELECTRICAL: 120/208V SYSTEM, PANELS, LIGHTING
 PLUMBING: RESTROOMS, SINKS, SHOWERS
 ELEVATORS: 2 ELEVATORS
 STAIRS: 2 STAIRS
 EXTERIOR: 25' DI. FOR PLAY PLAYGROUND

PFA Design Group
 ARCHITECTS AND PLANNERS

615
 Capital of Texas Hwy., S.
 Suite 200
 Austin, Texas 78746
 (512)328-2209

THIS PLAN IS THE PROPERTY OF PFA DESIGN GROUP, INC. AND IS NOT TO BE REPRODUCED OR TRANSMITTED IN ANY FORM OR BY ANY MEANS, ELECTRONIC OR MECHANICAL, INCLUDING PHOTOCOPYING, RECORDING, OR BY ANY INFORMATION STORAGE AND RETRIEVAL SYSTEM, WITHOUT THE WRITTEN PERMISSION OF PFA DESIGN GROUP, INC. ALL RIGHTS ARE RESERVED.